

Terminations & Loads

Model 1446 Medium Power, 7/16 Connectors Low Intermodulation Design

25 Watts
dc to 6.0 GHz



PHYSICAL DIMENSIONS:

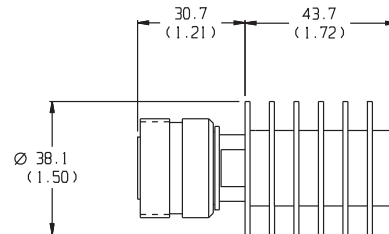

MODEL NO. 1446-1 FEMALE

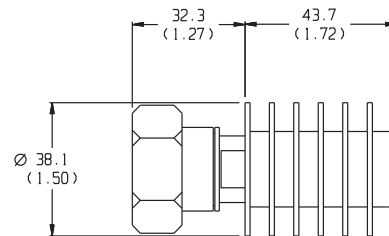

MODEL NO. 1446-2 MALE

NOTE: All dimensions are given in mm (inches) and tolerances are X.X+0.8 (0.3) unless otherwise specified.

Features

- /// Optimized for Wireless OEM and Test Applications.
- /// Designed to meet environmental requirements of MIL-D-39030.
- /// Custom Designs Available.

Specifications

NOMINAL IMPEDANCE: 50 Ω

FREQUENCY RANGE: dc to 6.0 GHz

MAXIMUM SWR:

Frequency (GHz)	SWR
dc - 6	1.20

POWER RATING: (mounted horizontally assuming unobstructed air flow and natural convection around unit): 25 watts **average** @ 25°C ambient temperature, derated linearly to 2.5 watts @ 125°C. 5 kilowatts **peak** (5 μ sec pulse width; 0.25% duty cycle).

INTERMODULATION: IM3 (Reflected) = -100 dBc with two +41 dBm Input Tones @ 869 MHz and 891 MHz.

TEMPERATURE RANGE: -55°C to 125°C.

TEST DATA: Swept data plots of SWR from 50 MHz to 18 GHz is available at additional cost.

CONNECTOR: 7/16 connector that conforms to DIN 47 223, IEC 1694, VG 95250, CECC 22190. Choice of 7/16 male(-2) of 7/16 female (-1) connector

CONSTRUCTION: Black, finned aluminum body, silver plated brass connector.

WEIGHT: Net 216 g (7.6 oz) maximum